

SLIFT KIT

SIMPLE | SMART | EFFICIENT



NOW AVAILABLE:

SLIFT AS A KIT

SIMPLE | SMART | EFFICIENT

Introducing the new RAICO SLIFT Kit System! Our new lift-and-slide door variant combines exceptional ease of fabrication with remarkable versatility. Smart design details make SLIFT especially simple and efficient to install.





Key Highlights

Reduced material use: All components included in the kit are limited to the essentials — for resource-efficient fabrication while maintaining high system performance.

Flexible configuration options: The RAICO SLIFT system allows customization for glass thickness, thermal insulation performance, and dimensions — allowing tailored solutions for a wide range of project requirements.

Efficient transport and easy handling: Thanks to the compact packaging of our SLIFT kit system, transport costs can be significantly reduced.

Optimized installation conditions: Pre-assembled sub-components ensure fast, precise, and time-saving installation. This reduces on-site assembly effort and increases process reliability.

High cost efficiency: The system provides a cost-effective alternative to fully pre-assembled lift-and-slide doors. Our smart kit solution lowers investment costs without compromising on quality or functionality.

CONFIGURATION of the kit

Type A+

- Sash glazing: from interior (GI)
- Fixed pane glazing: direct from exterior (GO)
- Frame for T-connections only – mitered joints in frame not possible

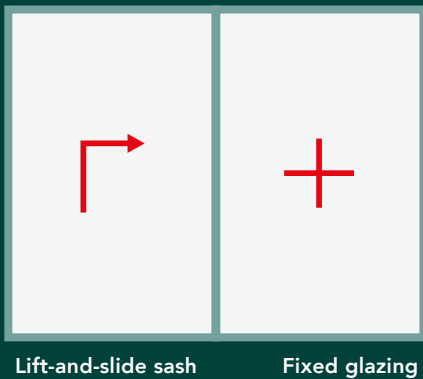

COMPONENTS for assembly

- ① Top frame
- ② Bottom frame
- ③ Side frame (sash)
- ④ Side frame (fixed panel)
- ⑤ Central mullion
- ⑥ Sliding sash (pre-assembled)
- ⑦ Accessories

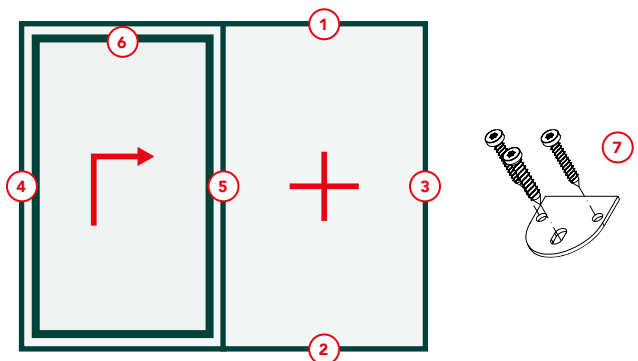

Includes 6 prefabricated parts and additional components



AVAILABLE SIZES depending on mode of transport

The maximum size of the SLIFT kit is determined by the selected mode of transport.
If larger formats are required, custom packaging should be arranged separately.
Increased transport costs may apply (see table on page 6).

Vertical Cross-Sections

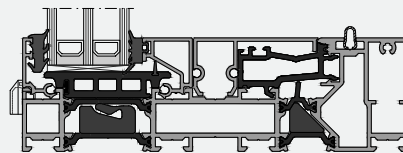
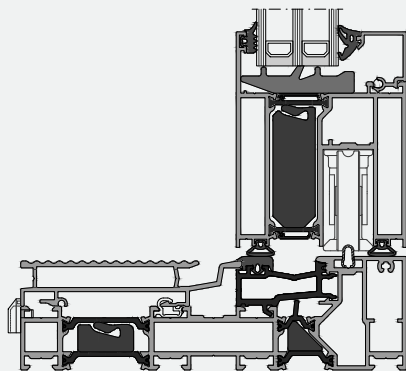
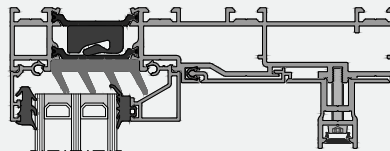
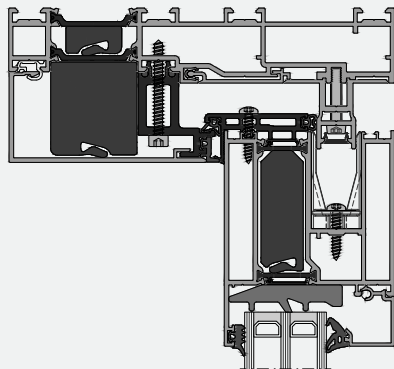

Lift-and-slide sash (FO, GI)

Fixed glazing (FO, GO)

Horizontal Cross-Sections

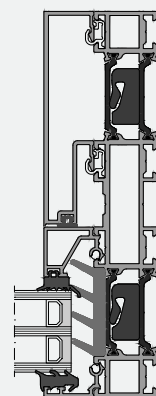
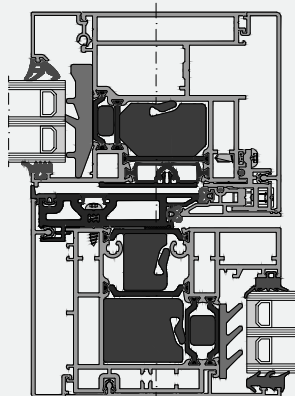
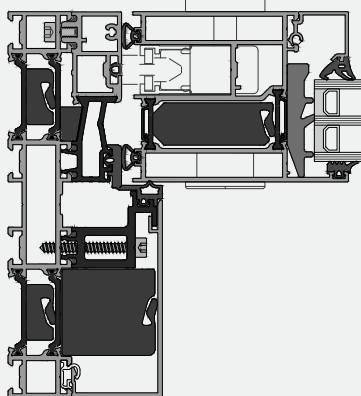

Lift-and-slide sash (FO, GI)

Mullion joint

Fixed glazing (FO, GO)

LOGISTICS

Key information on shipping and packaging

When shipping abroad, packaging specifications should be observed — for example, timber should comply with IPPC standards. Kits must not be shipped with pre-installed glazing. Glazing must always be done on-site.

Dimensions can be found in the following table:

Mode of Transport	Frame Kit Size (FRAME _w x FRAME _h)	Sash Kit Size (SASH _w x SASH _h)
HGV	6500 x 3298 mm	1600 x 3200 mm
Sea freight: 20-foot standard container	5700 x 3298 mm	1850 x 3200 mm
Sea freight: 40-foot standard container	6500 x 3298 mm	1850 x 3200 mm
Sea freight: 20 ft High Cube Container	5700 x 3298 mm	2200 x 3200 mm
Sea freight: 40 ft High Cube Container	6500 x 3298 mm	2200 x 3200 mm
Air freight	on request	

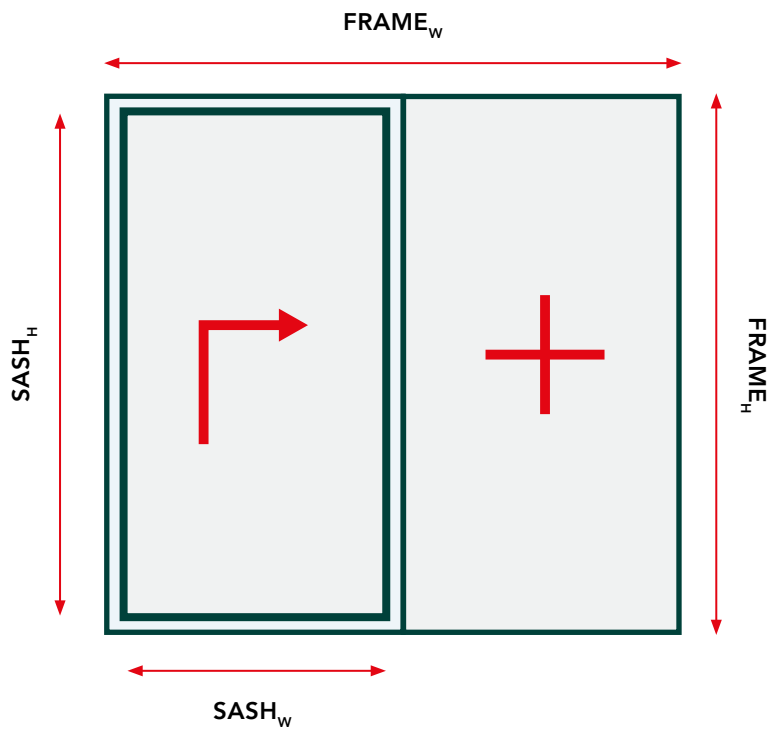

QUESTIONS? We're here to help!

Need more information on how to correctly process the SLIFT kit using Type A+? Or would you like to request relevant assembly and installation documents?

CALL +49 (0)8265 911-0

RAICO's team is always happy to assist you with any questions about your building project!

RAICO BAUTECHNIK GMBH
info@raico.com
Pfaffenhausen, DE

RAICO AUSTRIA
info.at@raico.com

RAICO SWISS GMBH
info.ch@raico.com
Aarau, CH

RAICO FRANCE S.À.R.L.
info.fr@raico.com
Entzheim, FR

RAICO UK
info.uk@raico.com
Gosport, UK

RAICO NORTH AMERICA
info.na@raico.com
Vancouver, CA

RAICO PACIFIC LTD.
info.au@raico.com
Canberra, AU

**RAICO BUILDING
TECHNOLOGY CO. LTD.**
info.cn@raico.com
Kunshan, CN