

FRAME⁺ 75 DI door system fittings

Conversion

Secondary strike plate automatic deadbolt

For our FRAME⁺ 75 DI aluminium door system, the secondary strike plate and the corresponding magnetic contact will be changed in all locks for automatic deadlocks **from week 27**.

For new orders, the new articles are automatically included in all sets delivered after the cut-off date. These can also be installed in already machined outer frame profiles, as the profile machining is identical for old and new strike plates.

Advantages at a glance

- Due to its design and the different shape of the upper and lower recesses in the strike plate, the magnetic contact can only be installed in the correct position and in the appropriate recess
- Due to its design, the magnetic contact can no longer fall out of the strike plate without external influence
- The non-adjustable strike plate of the locks for 2-leaf solid panic doors is provided with a housing in the new version



Please note

If magnetic contacts and/or secondary strike plates are required as replacements for previously delivered doors, the secondary strike plate and magnetic contact must always be replaced together, as the old magnetic contacts cannot be installed in new strike plates and new magnetic contacts cannot be installed in old strike plates. If necessary, please contact our customer service or customer support quoting the item no. of the lock originally ordered.

If you need to dismantle the new magnetic contact, we will be pleased to send you an appropriate dismantling tool. In this case, please also contact the customer service or customer support.

adjustable version

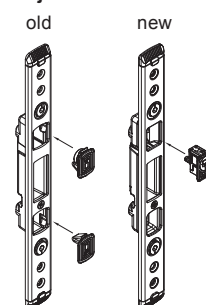

non adjustable version

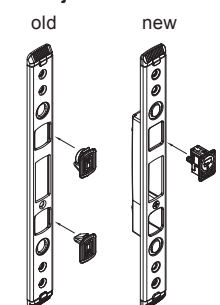

current processing information on the following page

Updates | 2021.1

Mounting and assembly

Main strike plate/striker for multi-point locks/mortise locks/multi-point locks

Mounting of cover caps

Break the cover caps apart and attach from above and below

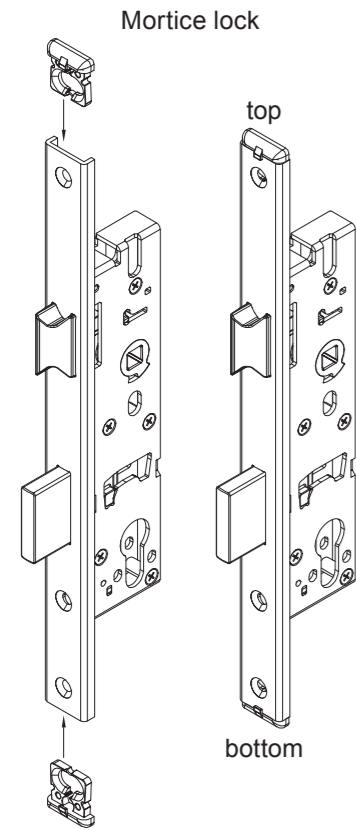

Striker for multi-point locking bolt

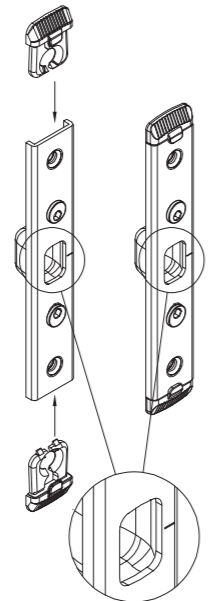

Attention: Marking on the side of the opening direction.

Striker for multi-point locking hook bolts

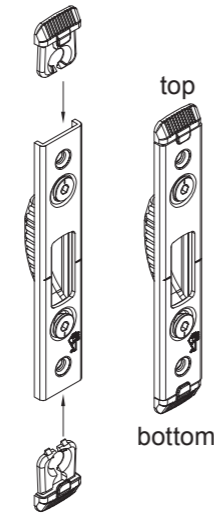

Striker for multi-point locking, automatic bolt lock

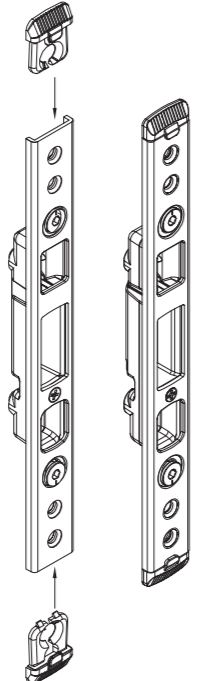

Mount the magnetic contact. Insert magnet into top hole of striker plate

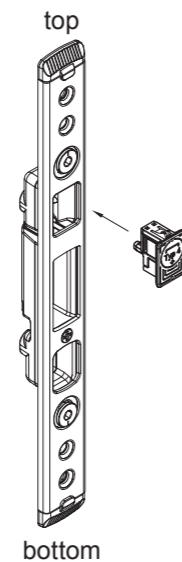

Multiple lock

For FH <2040 mm, shorten the top of the lock faceplate by 30 mm.

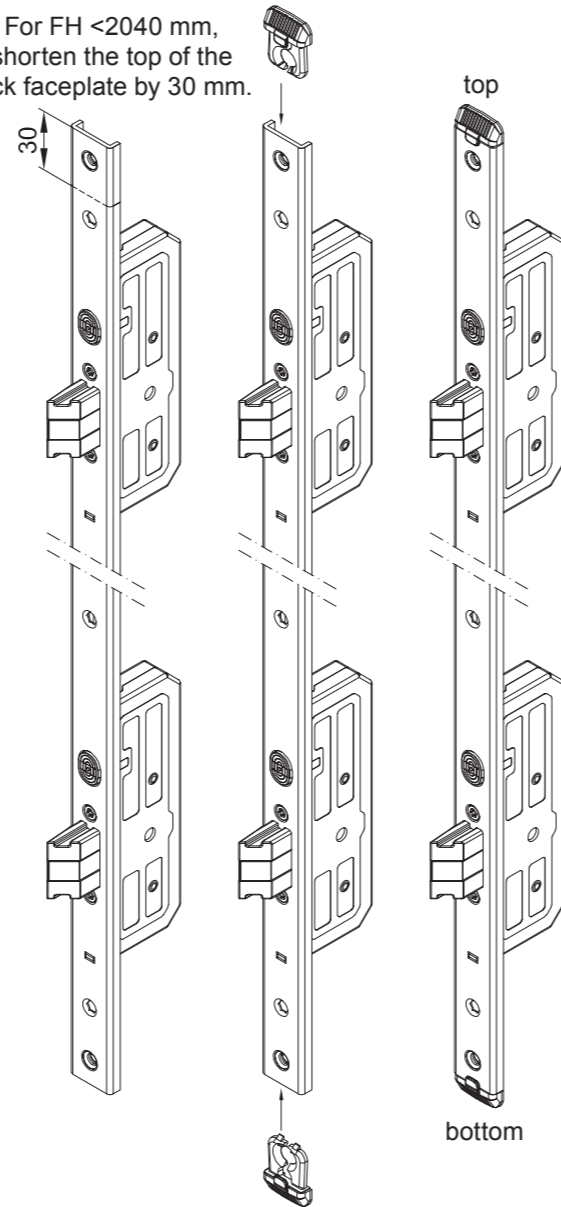

Mounting of anti-drilling insert in the RC version

Remove the protective foil

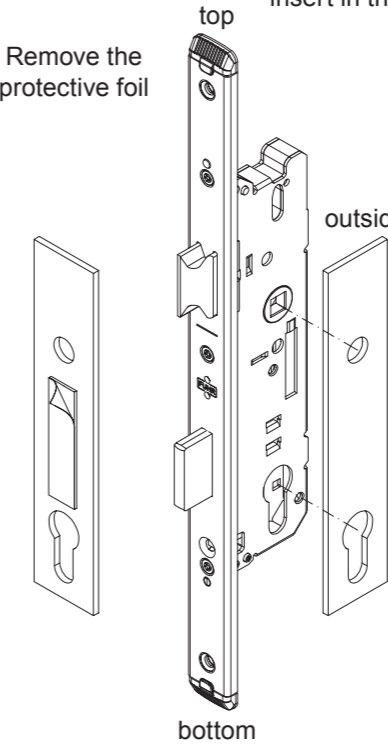

Self-adhesive drilling protection insert, stick on the outside

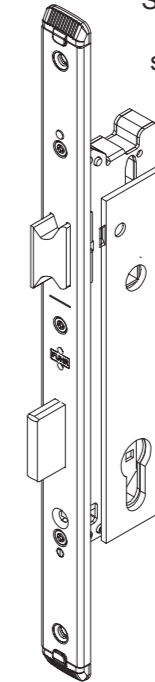

Screw connection on the profile

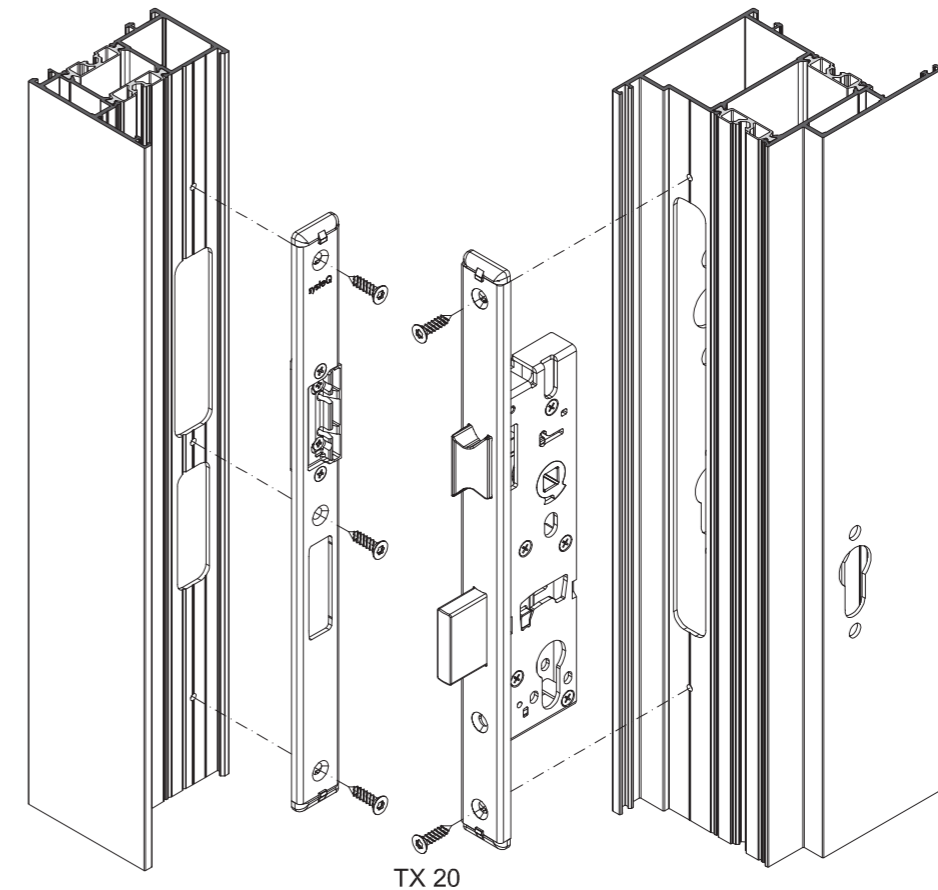

Push into the profile and fasten with screws 908016. Position/number of screw connections as specified in profile finishing. When installing the hardware components, note the alignment (top/bottom). For versions with an electric strike or bolt switch contact, leave a 10 to 15 cm cable loop for dismantling the strike plate.